

GMP 200.30.A - GMP 200.30.VAR

INFORMACIÓN ÚTIL PARA LA INSTALACIÓN

FRONTAL



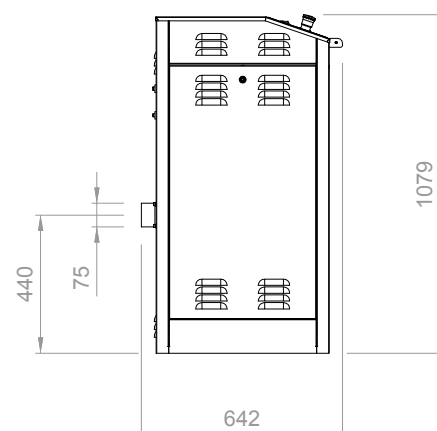

LATERAL

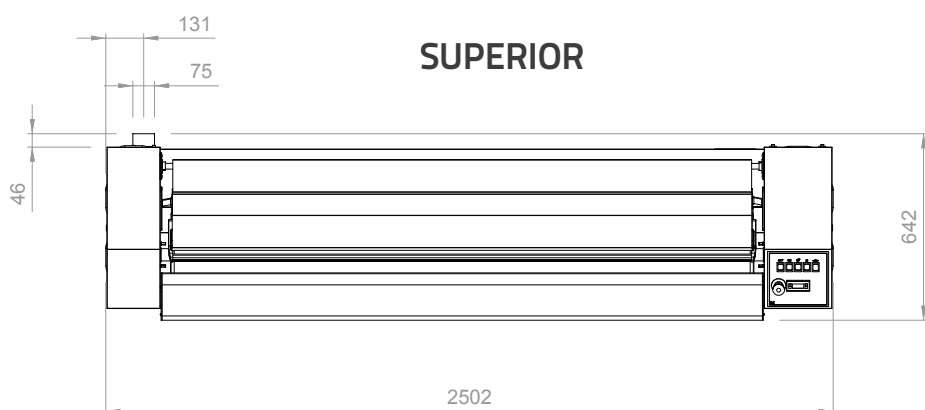

SUPERIOR



REQUISITOS

Cable eléctrico + enchufe industrial			
	V.230/1/50-60Hz	V.230/3/50-60Hz	V.400/3N/50-60Hz
	n/d	46 A	26,5 A
Potencia total	n/d	16,1 kW	16,1 kW
Interruptor magnetotérmico diferencial	n/d	$I_{dn} = 0.03 \text{ A}$	$I_{dn} = 0.03 \text{ A}$
Extracción de vapores	n/d	$\varnothing 75 \text{ mm}, 90 \text{ m}^3/\text{h}$	$\varnothing 75 \text{ mm}, 90 \text{ m}^3/\text{h}$
Espacio requerido alrededor de la planchadora	detrás: 400 mm - derecha: 650 mm - izquierda: n/d		